

1

2

3

4

### TOP VIEW

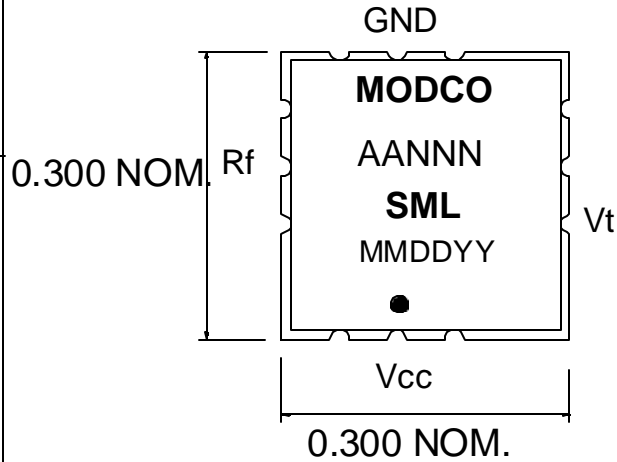

### SIDE VIEW

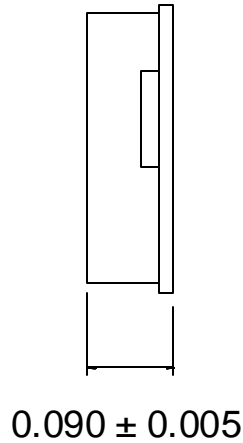

### BOTTOM VIEW

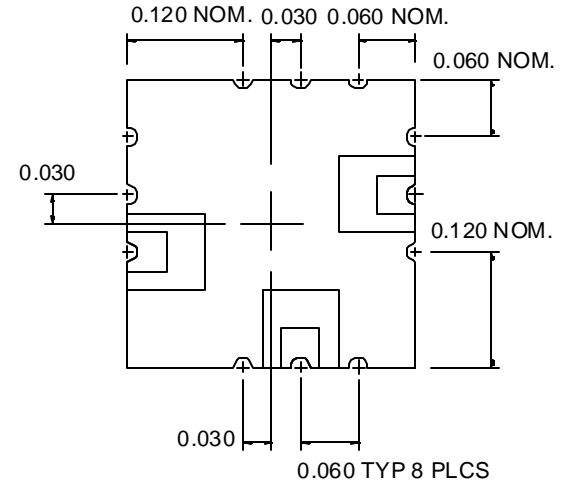

- Notes:
1. The case is ground.
  2. Soldermask/pad layout may vary depending on model, consult factory.
  3. Unless otherwise specified all dimensions are in inches.

Part labeling  
 Part number: AA=Alpha pre-fix, product family or custom part designator.  
 NNN=Numeric 3 to 4 digit specific part number  
 Part type: 2 to 4 alpha part type designator  
 Date code: MM=month, DD=day, YY=year  
 Label material is high temp. polyester film, opaque white, with black marking.

### Solder mask/pad details see note 2

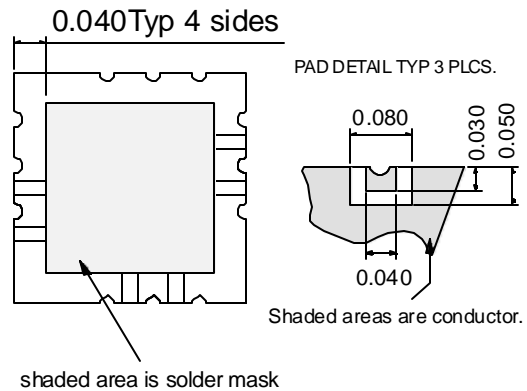

**MODCO**

Part # → AANN

Part type → SML

Date code → MMDDYY

Dot indicates Vcc →

A		Released on new format.	
Revision History			
DATE:	09/16/03	<b>MODCO, INC.</b> 806 PACKER WAY SPARKS NV 89431 TEL: (775) 331-2442 FAX: (775) 331-6266	
BY:	D. Johnson		
CHECKED:			
REV:	A		
DRAWING #:	SML_SPEC.mkd	TITLE:	SML PACKAGE OUTLINE

1

2

3

4